

DIAGRAMS & PARTS LIST

IK-12MAX

TORCH L-100



DIAGRAM

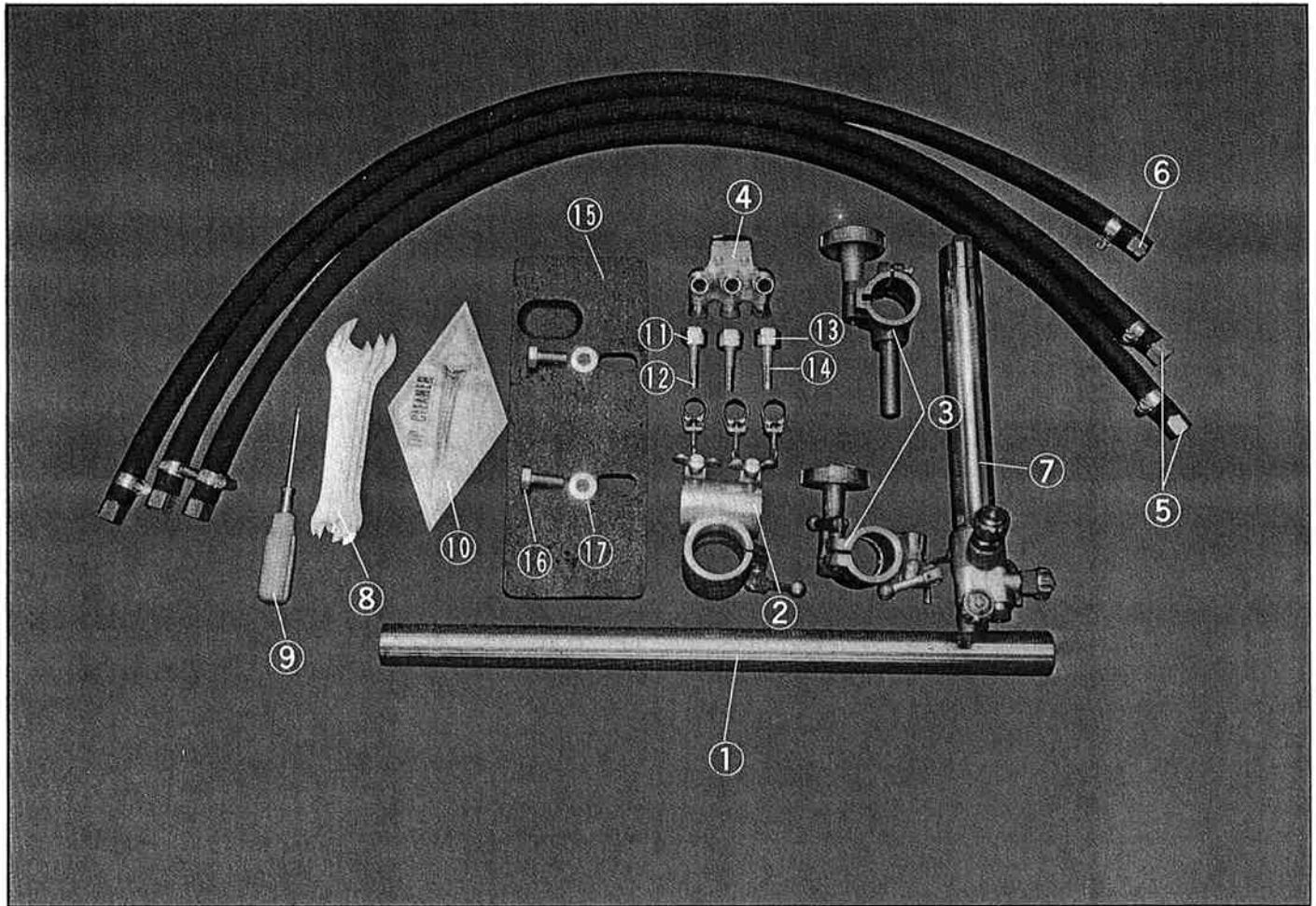

PARTS LIST

ITEM NO.	PART NAME	Q'TY	PART NO.	STOCK NO.	REMARKS
1	Pipe arm	1	10401-10T02	30321	500mm
2	Arm holder unit	1	10401-10V00	30301	
3	Torch holder assembly	1	10607-10A00	30367	
4	Distributor	1	F2003-10000-A	13301	Except U.S.A.
			F2004-10000-B	13302	U.S.A. only
5	Hose for oxygen	2	10607-10R21-A	30368	Except U.S.A.
			10607-10R21-B	30369	U.S.A. only
6	Hose for gas	1	10607-10R22-A	30370	Except U.S.A.
			10607-10R22-B	30371	U.S.A. only
7	Torch	1	F3401-10000	10701	Except U.S.A.
			F3402-10000	10702	U.S.A. only
8	Spanner	1	10601-80B00	30309	
9	Screw driver	1	10601-80C00	30310	
10	Tip cleaner	1	10601-80D00	30311	
11	Nut for oxygen	2	00F03	15001	Except U.S.A.
					M16xP1.5
12	Hose connector	2	00E03	15003	Except U.S.A.
					5/16
13	Nut for gas	1	00F04	15002	Except U.S.A.
					M16, P1.5, Right
14	Hose connector	1	00E04	15004	3/8
15	Weight	1	10602-80G00	30346	
16	Hex bolt	2	10602-80A01	BH-10X35	M10x35
17	Washer	2	10602-80A02	WF-10	φ10



IK-12MAX TORCH L-100

DIAGRAM

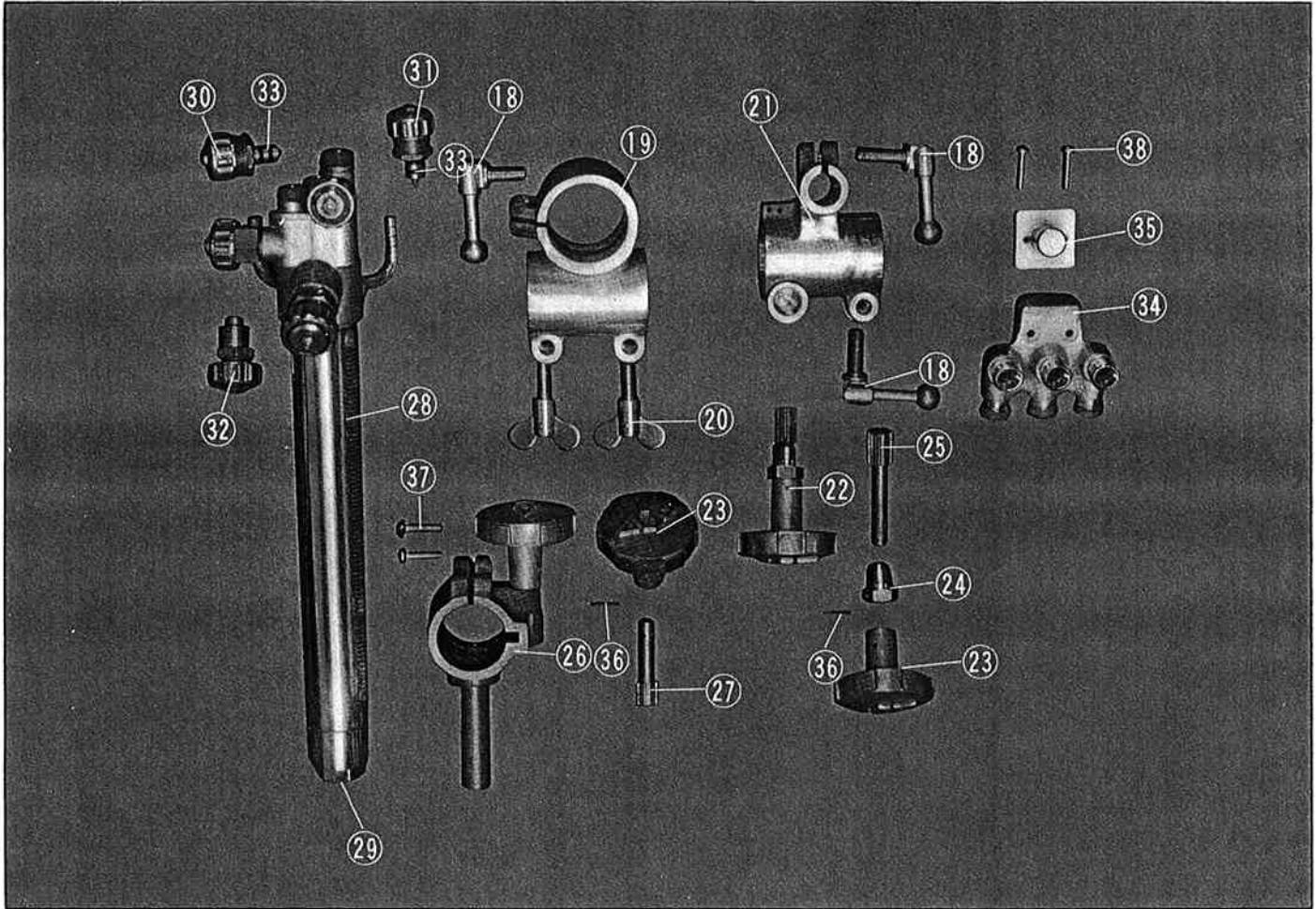

PARTS LIST

ITEM NO.	PART NAME	QTY	PART NO.	STOCK NO.	REMARKS
18	Crank handle	1	I0401-10V01	30313	
19	Arm holder base	1	I0401-10V02	30314	
20	Wing bolt	3	I0401-10V03	30315	
21	Cross feed holder	1	I0607-10A01	30372	With key
22	Cross feed handle assembly	1	I0607-10A00-A	30373	
23	Handle	2	I0401-10X01	30317	
24	Pinion metal	1	I0607-10A02	30374	
25	Pinion	1	I0607-10A03	30375	
26	Torch holder assembly	1	I0607-10A00-B	30376	
27	Pinion	1	I0607-10A04	30377	
28	Torch rack	1	F3401-10A07	10703	With screw
29	Tip fixing nut	1	00F05	5020	
30	Valve for preheat oxygen	1	250E-B6701	15105	
31	Valve for gas	1	250R-B6701	15103	
32	Valve for jet oxygen	1	280B-A00	15122	
33	O-Ring		KS-5	5026	
34	Distributor body	1	F2003-10A01	13303	
			F2004-10A01	13304	U.S.A. only
35	Distributor bracket	1	F1602-10A02	13305	
36	Spring pin	2	I0601-80A01	PR-2.5X16	#2.5X16
37	Screw	2	I0605-80A13	SP-4X18	M4x18
38	Screw	2	I0605-80A14	SP-4X30	M4x30



KOIKE SANSO KOGYO CO., LTD.

4-8, Taihei 3-chome, Sumida-ku, Tokyo, Japan
Telephone : Tokyo 03-3624-3111