

DIAGRAMS & PARTS LIST



9Y3-00B07-2

90-B

IK-12MAX

TORCH S-200

DIAGRAM

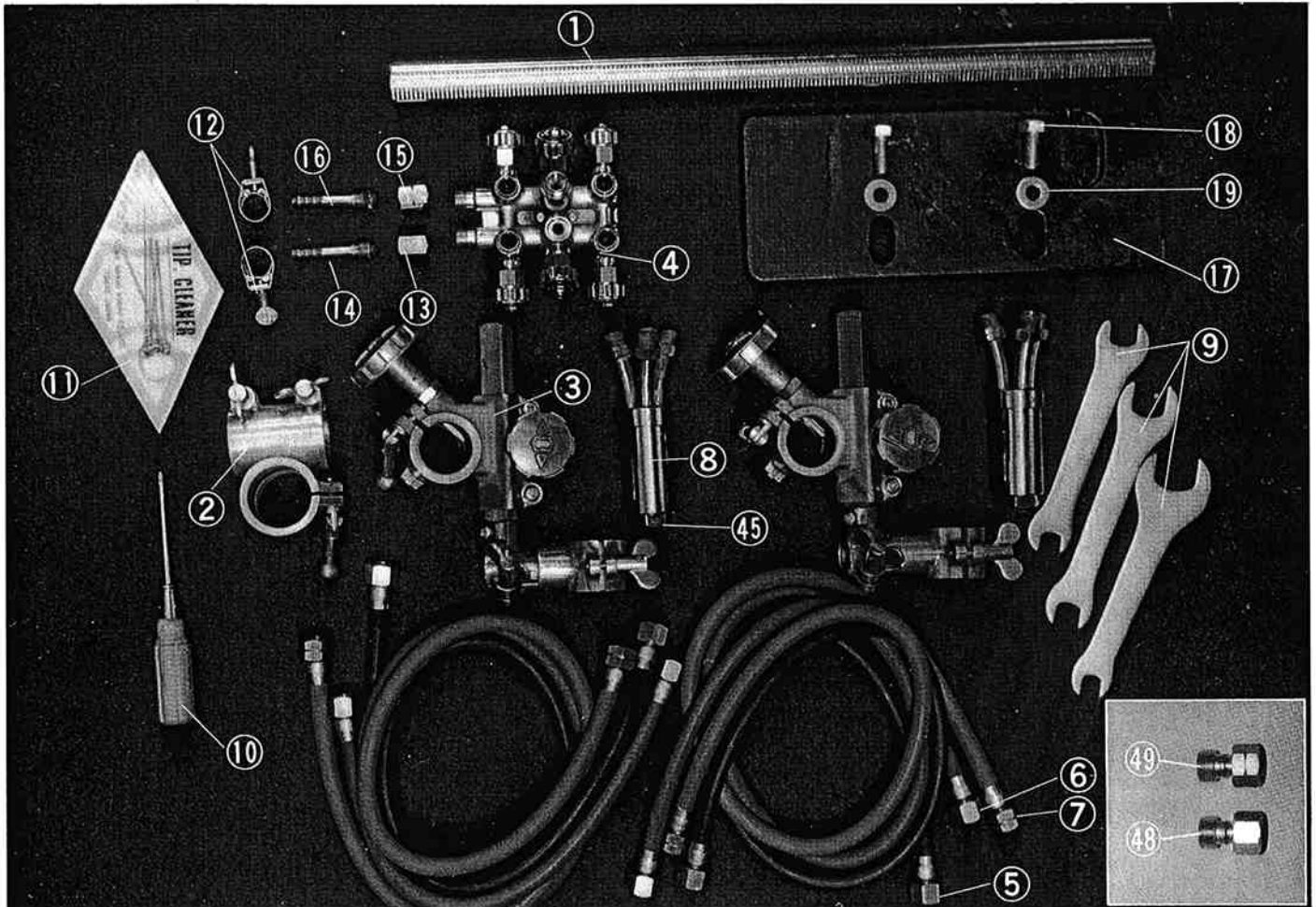

PARTS LIST

ITEM NO.	PART NAME	QTY	STOCK NO.	REMARKS
1	Pipe arm	1	30321	Standard 500mm
2	Arm holder	1	30301	
3	Holder (B Type)	2	30302	
4	Distributor	1	13251	Except U.S.A.
		1	13252	U.S.A. only
		1	13256	K.E. only
5	Hose for jet oxygen	2	30322	Except U.S.A.
		2	30323	U.S.A. only
		2	30324	900L
		2	30324	K.E. only
6	Hose for preheat oxygen	2	30324	Except U.S.A.
		2	30324	900L
			30325	U.S.A. only
7	Hose for gas	2	30326	Except U.S.A.
			30327	U.S.A. only
8	Torch	2	10601	Except U.S.A.
		2	10602	U.S.A. only
		2	10606	K.E. only
9	Spanner	1	30309	
10	Screwdriver	1	30310	
11	Tip cleaner	1	30311	
12	Hose band	2	30312	
13	Nut for oxygen	1	15001	Except U.S.A.
		1	15056	Except U.S.A.
		1	15003	M16xP1.5
14	Hose connector for oxygen	1	15003	Except U.S.A.
		1	15040	5/16
		1	15002	K.E. only
15	Nut for gas	1	15002	Except U.S.A.
		1	15054	M16xP1.5 Left
		1	15004	K.E. only
16	Hose connector for gas	1	15004	Except U.S.A.
		1	15062	3/8
		1	15062	K.E. only

ITEM NO.	PART NAME	QTY	STOCK NO.	REMARKS
17	Weight	1	30346	
18	Hex bolt	2	BH-10X35	M10x35L
19	Washer	2	WF-10	φ10
48	Hose joint		12917	K.E. only
49	Hose joint		12904	K.E. only



KOIKE SANSO KOGYO CO., LTD.



IK-12MAX TORCH S-200

DIAGRAM

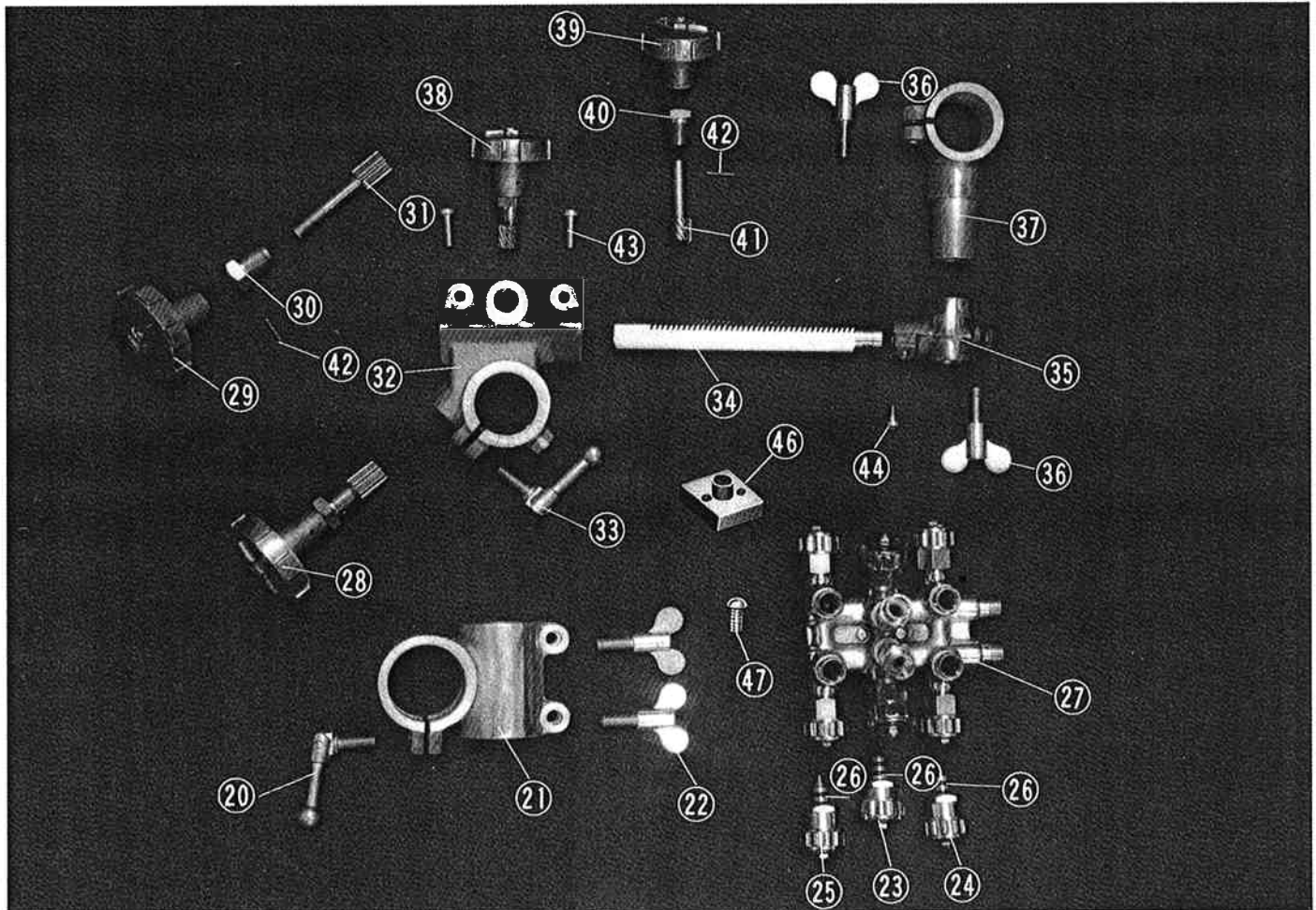

PARTS LIST

ITEM NO.	PART NAME	QTY	STOCK NO.	REMARKS
20	Crank handle	1	30313	
21	Bar holder	1	30314	
22	Wing bolt	2	30316	
23	Valve for jet oxygen	2	16251	Old No. 15114
24	Valve for preheat oxygen	2	16255	Old No. 15112
25	Valve for gas	2	15256	Old No. 15113
26	O-Ring		5026	
28	Cross feed assembly	1	30316	
29	Handle	1	30317	
30	Pinion metal	1	30318	
31	Pinion	1	30319	
32	Cross feed unit	1	30320	With key
33	Crank handle	1	30313	
34	Slide bar	1	30390	
35	Torch holder bracket	1	30391	
36	Wing bolt	2	30392	
37	Torch holder	1	30393	
38	Up/down handle assembly	1	30394	
39	Handle	1	30223	
40	Pinion metal	1	30395	
41	Pinion	1	30396	
42	Spring pin	2	PR-2.6X16	ø2.5x16L
43	Screw	2	SP-6X18	M6x18L
44	Screw	1	SP-5X10	M5x10L
45	Tip fixing nut		5020	
46	Distributor bracket	1	32347	
47	Screw	2	SP-4X20	M4x20L