

DIAGRAMS & PARTS LIST



9Y3-12B05-2

91-A

IK-12MAX

TORCH S-100

DIAGRAM

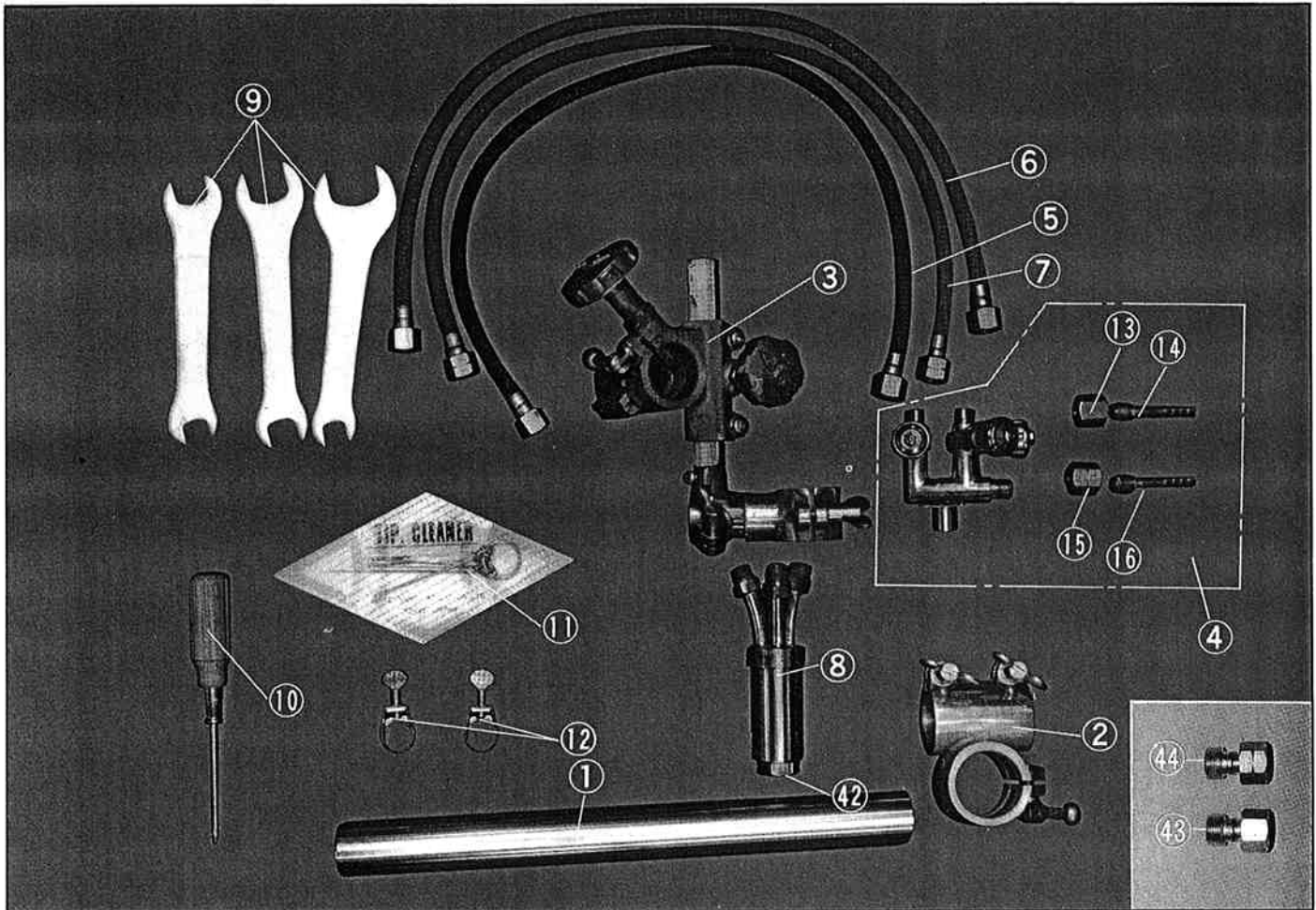

PARTS LIST

ITEM NO.	PART NAME	QTY	STOCK NO.	REMARKS
1	Pipe arm	1	30300	Standard 350mm
2	Bar holder assembly	1	30301	
3	Torch holder (B Type)	1	30302	
4	Distributor assembly	1	13201	Except U.S.A., K.E.
			13202	U.S.A. only
			13205	K.E. only
5	Hose for jet oxygen	1	30303	Except U.S.A., K.E.
			30304	U.S.A. only
			30305	K.E. only
6	Hose for preheat oxygen	1	30305	Except U.S.A.
			30306	U.S.A. only
7	Hose for gas	1	30307	Except U.S.A.
			30308	U.S.A. only
8	Torch	1	10601	Except U.S.A., K.E.
			10602	U.S.A. only
			10606	K.E. only
9	Spanner	1	30309	
10	Screw driver	1	30310	
11	Tip cleaner	1	30311	
12	Hose band	2	30312	Except U.S.A.
13	Nut for oxygen	1	15001	Except U.S.A., K.E.
			15056	K.E. only
14	Hose connector for oxygen	1	15003	Except U.S.A., K.E.
			15040	K.E. only
15	Nut for gas	1	15002	Except U.S.A., K.E.
			15054	K.E. only
16	Hose connector for gas	1	15004	Except U.S.A., K.E.
			15062	K.E. only

ITEM NO.	PART NAME	QTY	STOCK NO.	REMARKS
43	Hose joint	1	12917	K.E. only
44	Hose joint	1	12904	K.E. only



KOIKE SANZO KOGYO CO., LTD.



IK-12MAX TORCH S-100

DIAGRAM

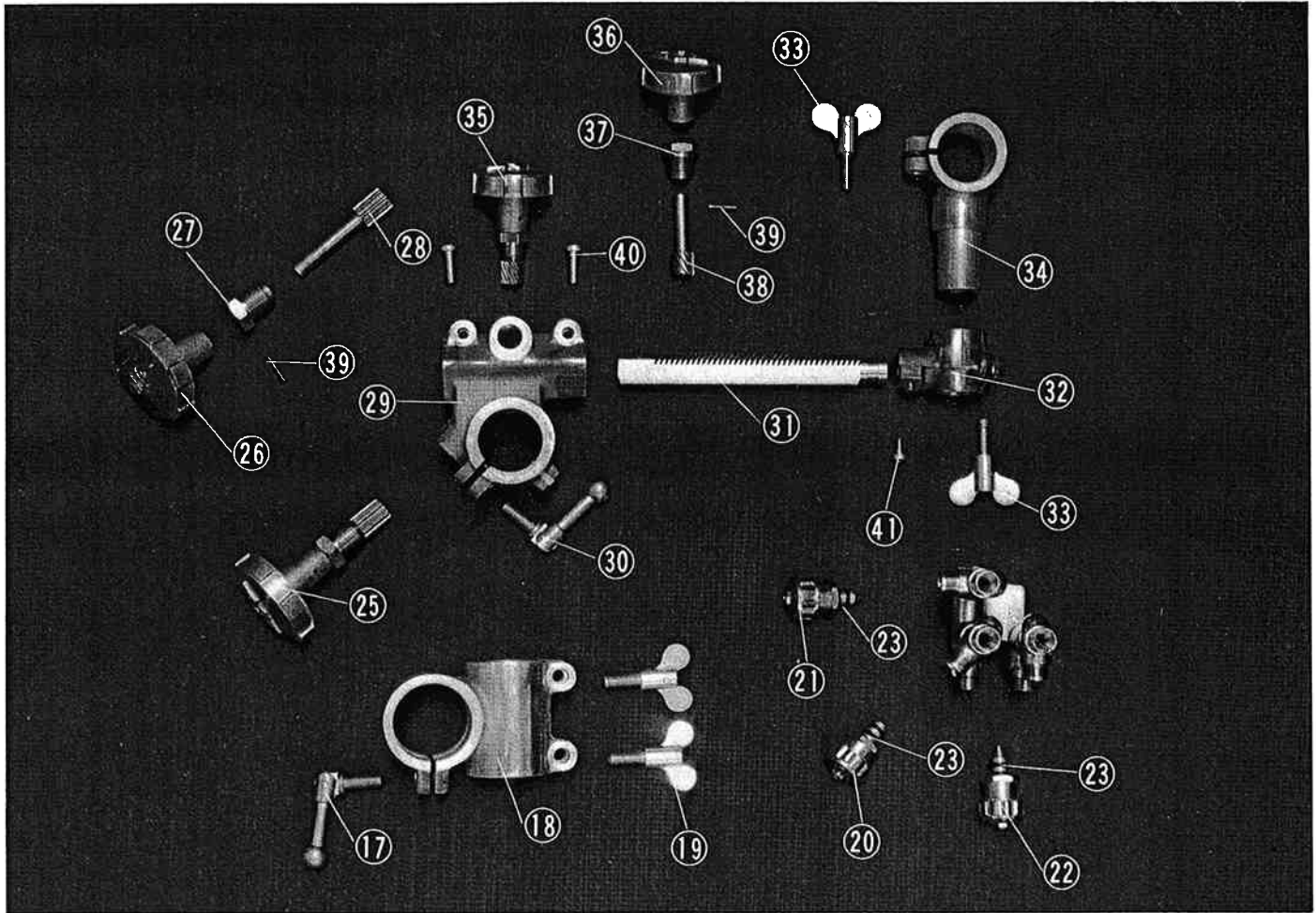

PARTS LIST

ITEM NO.	PART NAME	QTY	STOCK NO	REMARKS
17	Crank handle	1	30313	M8
18	Arm holder	1	30314	
19	Wing bolt	2	30315	M8
20	Valve for jet oxygen	1	15251	
21	Valve for preheat oxygen	1	15255	
22	Valve for gas	1	15256	
23	O-Ring		5026	
25	Cross feed handle assembly	1	30316	
26	Handle	1	30317	φ50
27	Pinion metal	1	30318	
28	Pinion	1	30319	
29	Cross feed unit	1	30320	With key
30	Crank handle	1	30313	
31	Slide bar	1	30390	
32	Torch holder bracket	1	30391	
33	Wing bolt	2	30392	
34	Torch holder	1	30393	
35	Up/down handle assembly	1	30394	
36	Handle	1	30223	
37	Pinion metal	1	30395	
38	Pinion	1	30396	
39	Spring pin	2	PR-2.5X16	
40	Screw	2	SP-6X18	
41	Screw	1	SP-5X10	
42	Tip fixing nut	1	5020	